

2003-2004 MAZDA 6 Electronic Climate Control

- 1 Disconnect the negative battery terminal to prevent an accidental short circuit.
- 2 Unscrew the shift knob counter clockwise to remove. (Figure A)
- 3 Unclip and remove the cup holder/parking brake cover and shifter cover as one unit. (Figure B)
- 4 Remove (2) Phillips screws from the bottom of the radio/climate control panel. (Figure C)
- 5 Open glove box, squeeze sides together and let open fully then remove (1) 10 MM bolt from the side of the radio bracket. (Figure D)

A

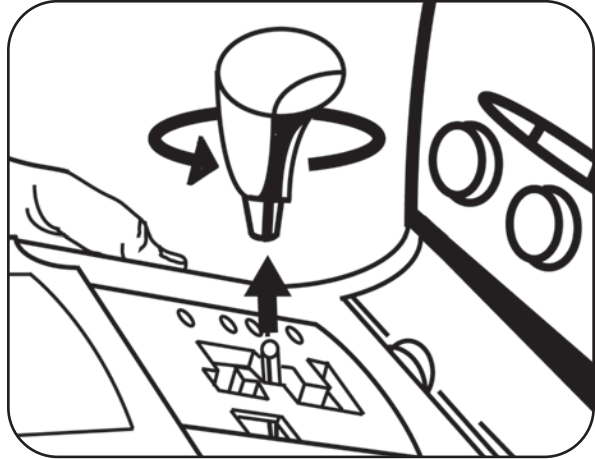

B

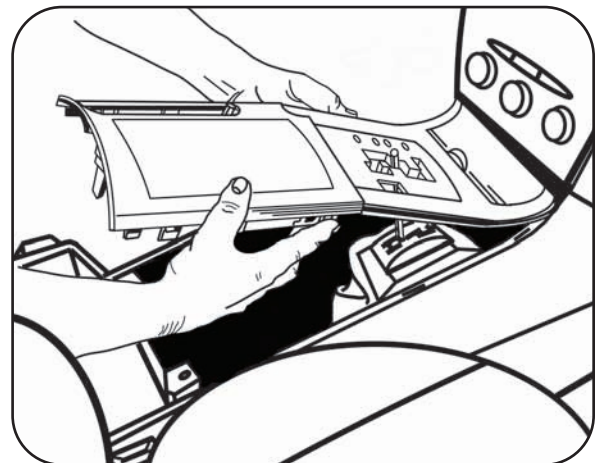

C

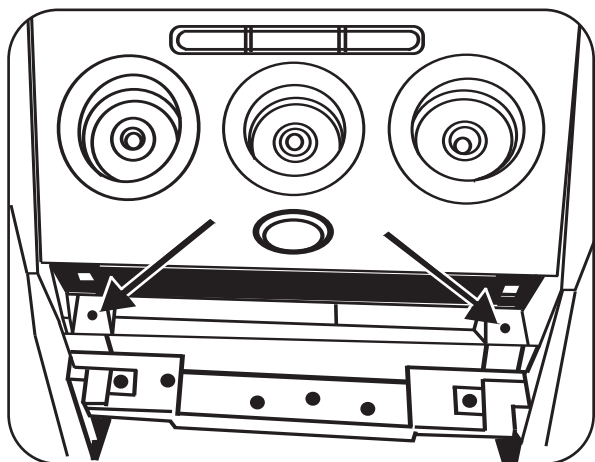

D

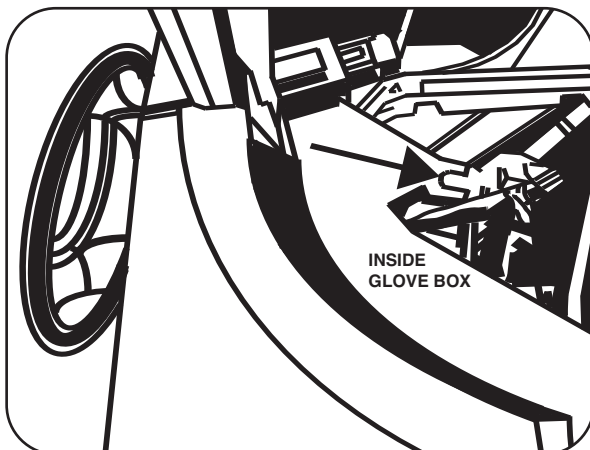

2003-2004 MAZDA 6 Electronic Climate Control

6 Unsnap and remove radio/climate control panel including climate control vents at the top. (Figure E)

7 Remove (4) Phillips screws securing vents to radio/climate control panel to remove. (Figure F)

8 Remove (8) Phillips screws securing the electronic climate control to the radio/climate control panel to remove. (Figure G)

9 Remove (4) Phillips screws securing the radio display harness bracket to the radio chassis then unclip and remove the radio display harness. (Figure H)

E

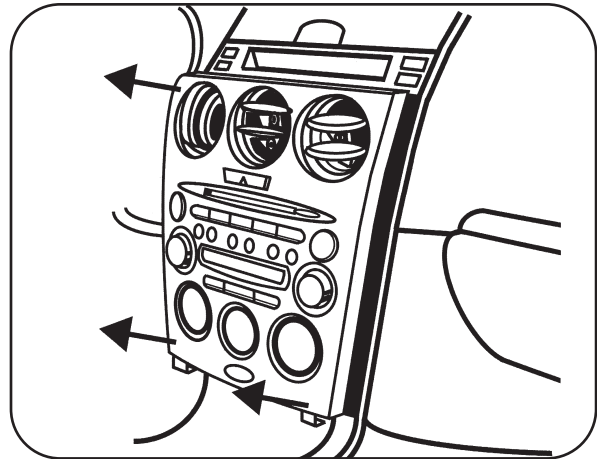

F

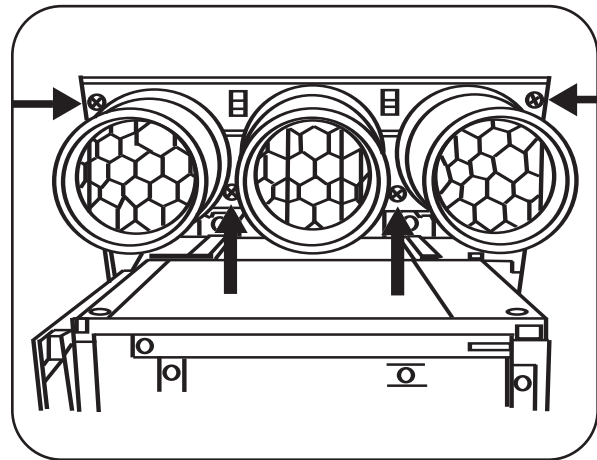

G

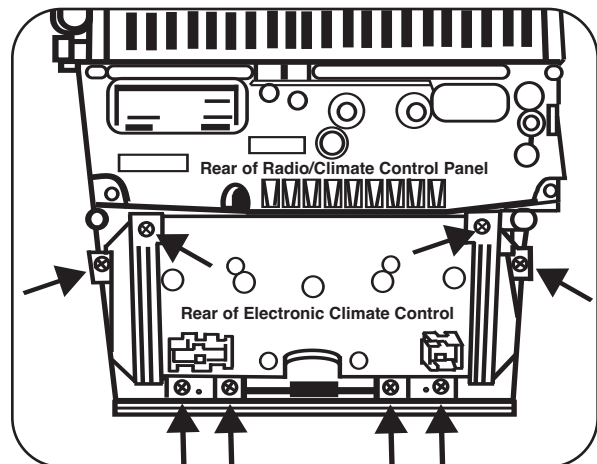

H

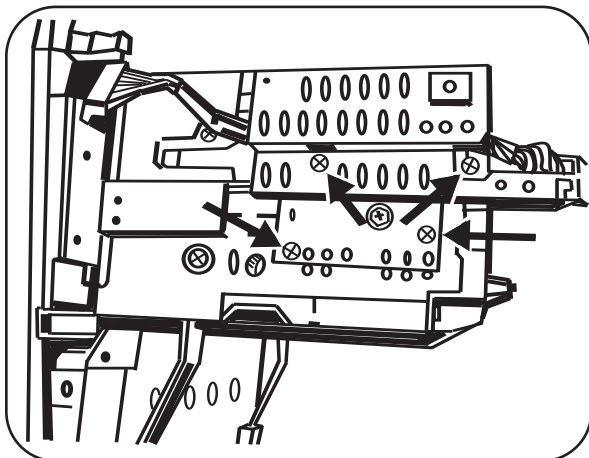

2003-2004 MAZDA 6 Manual Climate Control

- 1 Disconnect the negative battery terminal to prevent an accidental short circuit.
- 2 Unscrew the shift knob counter clockwise to remove. (Figure A)
- 3 Unclip and remove the cup holder/parking brake cover and shifter cover as one unit. (Figure B)
- 4 Remove (2) Phillips screws from the bottom of the radio/climate control panel. (Figure C)
- 5 Pull the climate control knobs off and remove (2) Phillips screws from behind knobs. (Figure D)

A

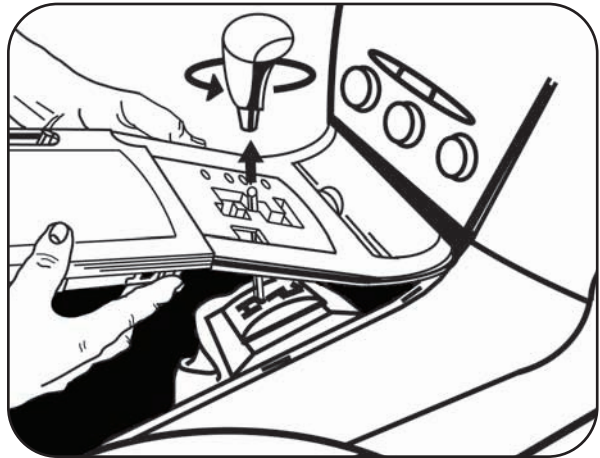

B

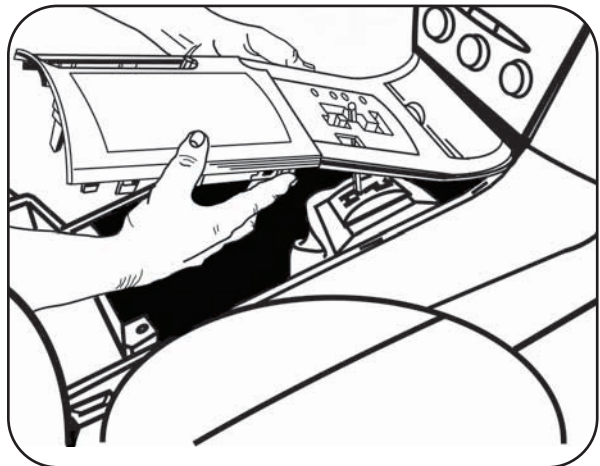

D

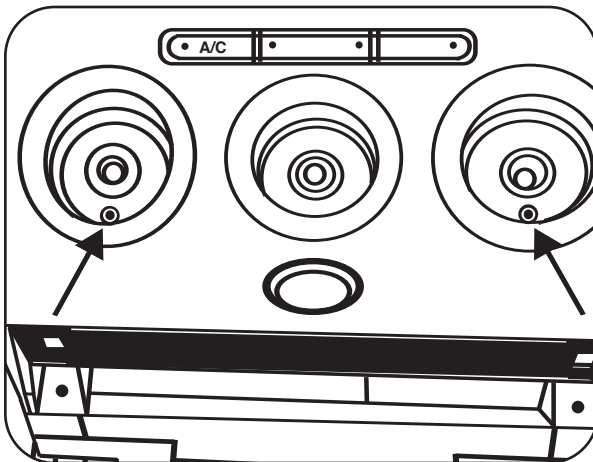

C

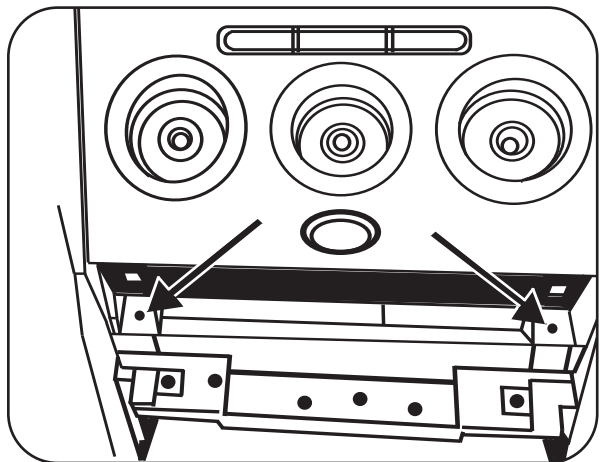

2003-2004 MAZDA 6 Manual Climate Control

6 Open glove box, squeeze sides together and let open fully then remove (1) 10 MM bolt from the side of the radio bracket. (Figure E)

E

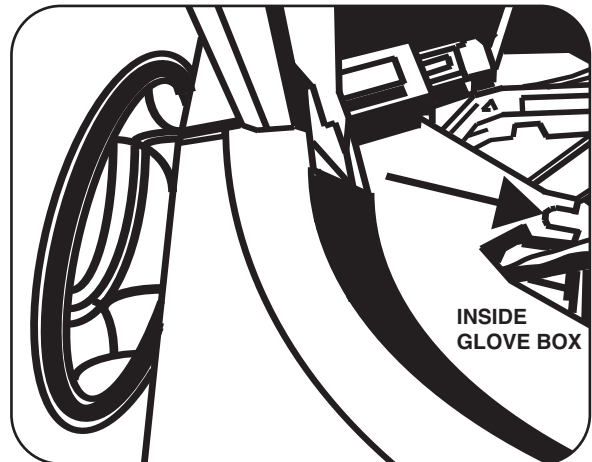

7 Unsnap and remove radio/climate control panel including climate control vents at the top. (Figure F)

F

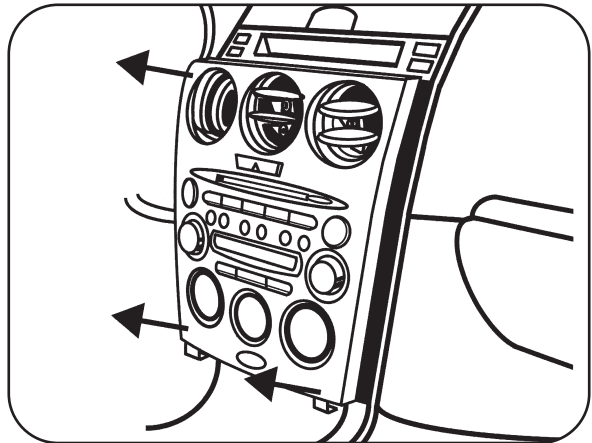

8 Remove (4) Phillips screws securing vents to radio/climate control panel to remove. (Figure G)

9 Remove the (2) small Phillips screws securing the light bulb boards on each side of the backlight dispersion bar. **Note:** Notice how they are positioned in the backlight dispersion bar as they will be placed in the 99-7503 the same way. (Figure H)

G

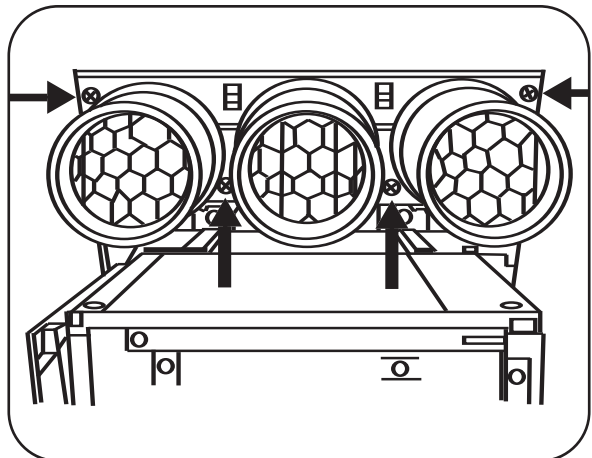

H

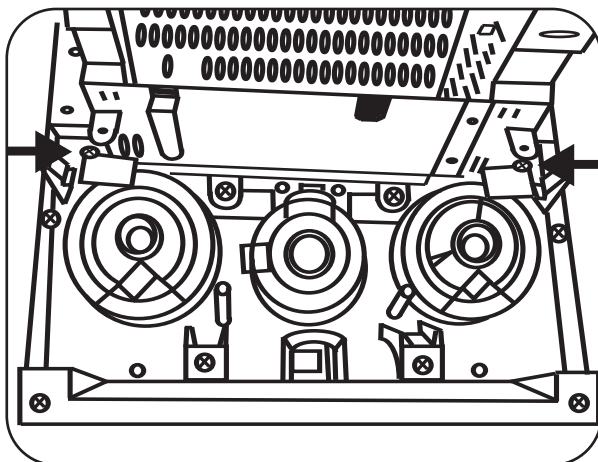

2003-2004 MAZDA 6 Manual Climate Control

- 10 Remove (4) Phillips screws securing backlight dispersion bar and knob trim bezels. (Figure I)
- 11 Push the bottom edges of the knob trim bezels from the front side to the back and slide both pieces out as one unit. (Figure J)
- 12 Remove (4) Phillips screws securing the radio display harness bracket to the radio chassis then unclip and remove the radio display harness. (Figure K)

I

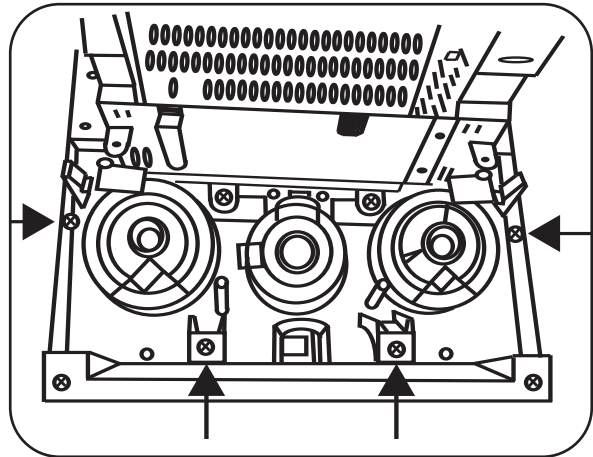

J

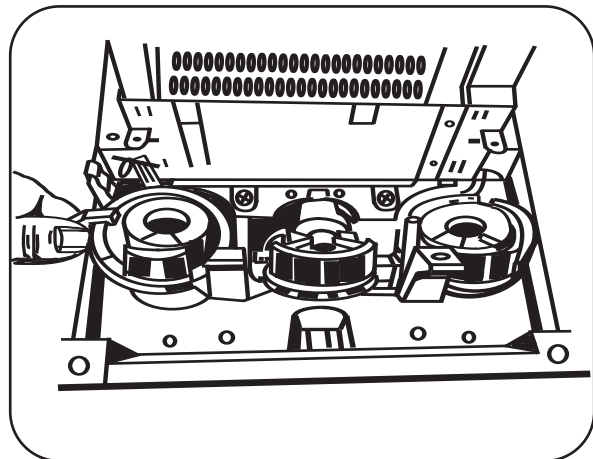

K

